

TEA TREE GULLY HERITAGE MUSEUM

3 PERSEVERANCE ROAD, TEA TREE GULLY

PHOTO BY MARK TAYLOR

STATE HERITAGE PLACE – No. 10951

This property was built as a hotel in 1854 and was associated with the early development of transport routes to the hinterland, with the early telegraph system and with the settlement of Tea Tree Gully. It served as a post office and telegraph station from 1880 to 1963.

The museum is open to the public on the third Sunday of every month from 1pm – 4pm. Check out the website for more information including how you can voluntarily get locked in with a ghost!

<http://www.ttgmuseum.on.net/events.html>

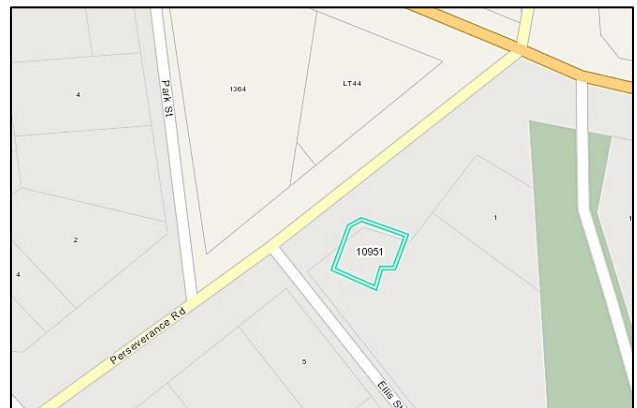

SA Heritage Places Database and Online map

http://maps.sa.gov.au/heritagesearch/HeritageItem.aspx?p_heritageno=3370

Heritage South Australia
Department for Environment and Water
P (08) 8124 4960
E DEWHeritage@sa.gov.au
www.environment.sa.gov.au/Heritage