

CROWN LANDS ACT 1929: SECTION 5

TAKE NOTICE that pursuant to the Crown Lands Act 1929, I PETER MACLAREN KENTISH, Surveyor-General and Delegate appointed by IAIN EVANS, Minister for Environment and Heritage, Minister of the Crown to whom the administration of the Crown Lands Act 1929 is committed DO HEREBY:

1. Dedicate the Crown Land defined in The First Schedule as a Reserve for District Council Purposes and declare that such land shall be under the care, control and management of the District Council of Cleve.
2. Dedicate the Crown Land defined in The Second Schedule as a Reserve for Conservation Purposes and declare that such land shall be under the care, control and management of the District Council of Cleve.

The First Schedule

Allotment 8 of DP 53746, Hundred of Boothby, County of Jervois, exclusive of all necessary roads.

The Second Schedule

Allotment 9 of DP 53746, Hundred of Boothby, County of Jervois, exclusive of all necessary roads.

Dated 31 July 2001.

P. M. KENTISH, Surveyor-General

DENR 08/0326

CROWN LANDS ACT 1929: SECTION 5

TAKE NOTICE that pursuant to the Crown Lands Act 1929, I PETER MACLAREN KENTISH, Surveyor-General and Delegate appointed by IAIN EVANS, Minister for Environment and Heritage, Minister of the Crown to whom the administration of the Crown Lands Act 1929 is committed DO HEREBY:

1. Resume the land defined in The First Schedule.
2. Dedicate the Crown Land defined in The Second Schedule as a Reserve for Natural Features Preservation and Sewerage Purposes and declare that such land shall be under the care, control and management of the Minister for Government Enterprises.

The First Schedule

Reserve for the purposes of the Preservation of Natural Features and Protection of Sewerage Works, section 639, Hundred of Adelaide, County of Adelaide, the proclamation of which was published in the *Government Gazette* of 15 May 1969 at page 1412, being the whole of the land comprised in Crown Record Volume 5715 Folio 227.

The Second Schedule

Allotment 101 of DP 56982, Hundred of Adelaide, County of Adelaide, exclusive of all necessary roads, subject nevertheless to:

1. An existing easement to the Commonwealth of Australia more particularly described in *Government Gazette* of 15 May 1969 at page 1412.
2. An easement to the Minister for Water Resources for drainage purposes over that portion of allotment 101 marked C on DP 56982.

Dated 31 July 2001.

P. M. KENTISH, Surveyor-General

DEHAA 17/1136 Pt 1

CROWN LANDS ACT 1929: SECTION 5

TAKE NOTICE that pursuant to the Crown Lands Act 1929, I PETER MACLAREN KENTISH, Surveyor-General and Delegate appointed by IAIN EVANS, Minister for Environment and Heritage, Minister of the Crown to whom the administration of the Crown Lands Act 1929 is committed DO HEREBY dedicate the Crown Land defined in The Schedule as a Reserve for Recreation, Access and Public Jetty Purposes and declare that such land shall be under the care, control and management of the District Council of Lower Eyre Peninsula, subject to the Jetty

Structure located on portion of the said land being subject to the same terms and conditions comprised in Memorandum of Lease No. 8902288 dated 17 May 2000.

The Schedule

Block 2, Hundred of Louth, County of Flinders, exclusive of all necessary roads, being the whole of the land comprised in Crown Record Volume 5838 Folio 288.

Dated 31 July 2001.

P. M. KENTISH, Surveyor-General

DENR 08/0545

DEVELOPMENT ACT 1993, SECTION 28 (5): DECLARATION OF CESSATION OF INTERIM OPERATION OF THE BERRI BARMERA COUNCIL—BERRI (DC) AND BARMERA (DC) DEVELOPMENT PLANS—GENERAL REVIEW AND CONSOLIDATION PLAN AMENDMENT

Preamble

On 27 July 2000 the Governor, under section 28 (1), declared The Berri Barmera Council—Berri (DC) and Barmera (DC) Development Plans—General Review and Consolidation Plan Amendment as an amendment to come into interim operation without delay on that day. The Berri Barmera Council Development Plan, consolidated on 27 July 2000, incorporated the provisions of The Berri Barmera Council—Berri (DC) and Barmera (DC) Development Plans—General Review and Consolidation Plan Amendment (incorporated into a published Development Plan pursuant to Section 31 of the Development Act 1993).

The Berri Barmera Council—Berri (DC) and Barmera (DC) Development Plans—General Review and Consolidation Plan Amendment has not been approved by the Minister under Section 25 within the required 12 months period.

As a result the Berri (DC) Development Plan dated 13 April 2000 and the Barmera (DC) Development Plan dated 30 September 1999 are the operative Development Plans.

NOTICE

PURSUANT to section 28 (4) (c) of the Development Act 1993, The Berri Barmera Council—Berri (DC) and Barmera (DC) Development Plans—General Review and Consolidation Plan Amendment ceases to operate under the Interim Operation Order proclaimed by the Governor on 27 July 2000.

Dated 2 August 2001.

DIANA LAIDLAW, Minister for Transport and Urban Planning.

DEVELOPMENT ACT 1993, SECTION 25 (17): CITY OF MOUNT GAMBIER—MOUNT GAMBIER (CITY) DEVELOPMENT PLAN—CAVE GARDENS AND ENVIRONS STATE HERITAGE AREA POLICY AREA PLAN AMENDMENT

Preamble

1. The Development Plan amendment entitled 'City of Mount Gambier—Mount Gambier (City) Development Plan—Cave Gardens and Environs State Heritage Area Policy Area Plan Amendment' (the Plan Amendment) has been finalised in accordance with the provisions of the Development Act 1993.

2. The Minister for Transport and Urban Planning has decided to approve the Plan Amendment.

NOTICE

PURSUANT to section 25 of the Development Act 1993, I:

- (a) approve the Plan Amendment; and
- (b) fix the day on which this notice is published in the *Gazette* as the day on which the Plan Amendment will come into operation.

Dated 2 August 2001.

DIANA LAIDLAW, Minister for Transport and Urban Planning

PLN 99/0026

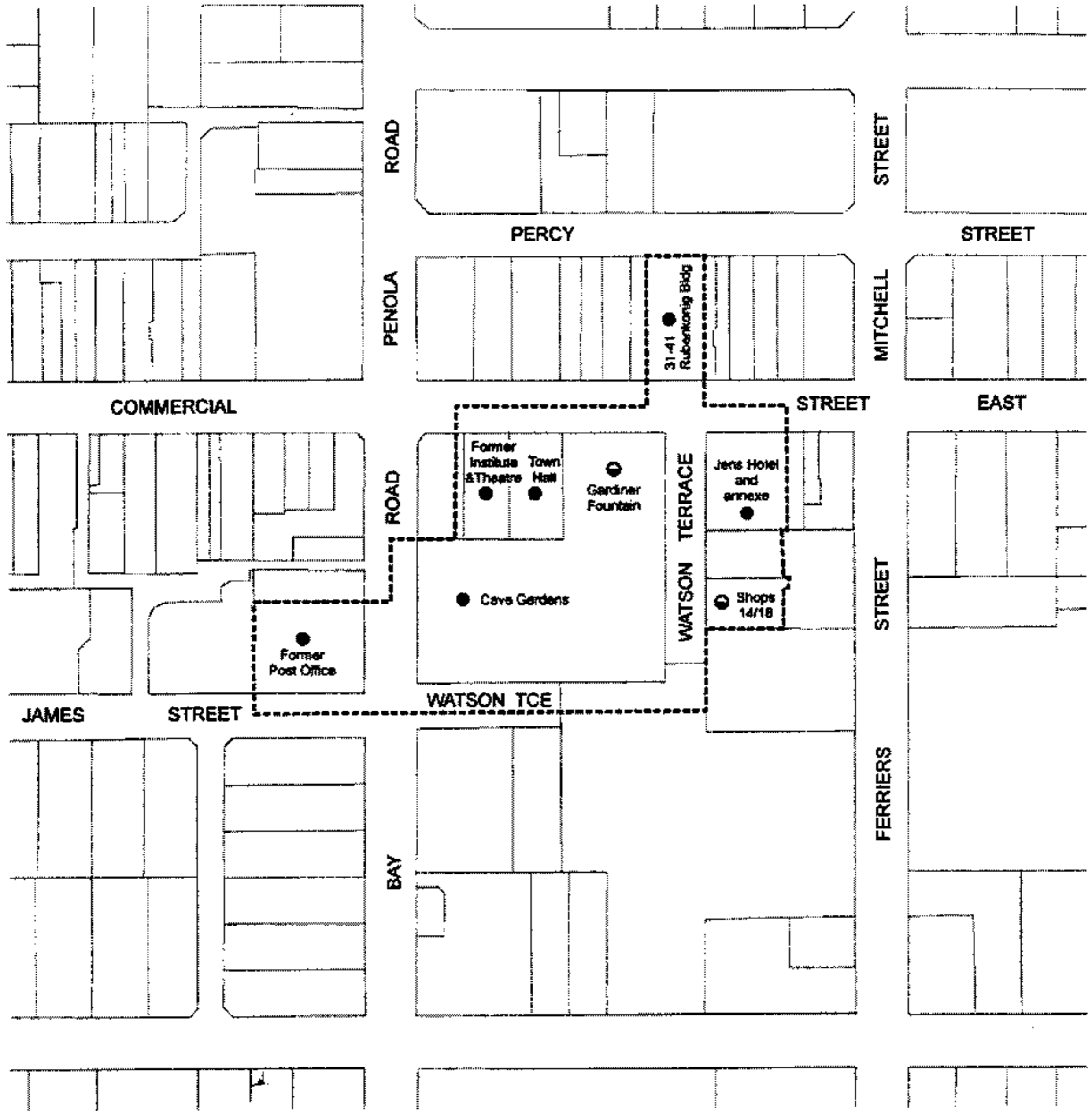

- Buildings entered in the State Heritage Register
- ⊙ Local Heritage Places

----- Cave Gardens and Environs State Heritage Area Policy Area Boundary

Scale 1:2500



MOUNT GAMBIER (CITY) CAVE GARDENS AND ENVIRONS STATE HERITAGE AREA POLICY AREA Figure CcE/3

Consolidated - 2 August 2001