

Australian Inland Mission

The house on this site was rented in 1895 as the first Presbyterian Manse in Beltana and was purchased in 1898. It served as the Manse for a line of missionaries including Rev John Flynn in 1911. This building became the Beltana Australian Inland Mission Nursing Home in 1919, - another building having been purchased to be used as the Manse. Named "The Mitchell Nursing Home", it was staffed by two nursing sisters who conducted their clinics regardless of the religious beliefs of patients. Advantages of the home were available to all. In 1927 the "Amy Fairfax Wing", a women's and maternity ward, was added to the original home, complete with the by then traditional AIM ventilated roof. Amy's father was a partner in the Fairfax media organisation and at her death in 1919 a bequest of £500 was made to the Presbyterian Australian Inland Mission. In addition to medical and health services, the sisters offered services and instruction in the Christian faith to the local community. The Nursing Home continued its services in Beltana until the mid 1950s when hospital facilities became available in Leigh Creek.

The property is now privately owned.

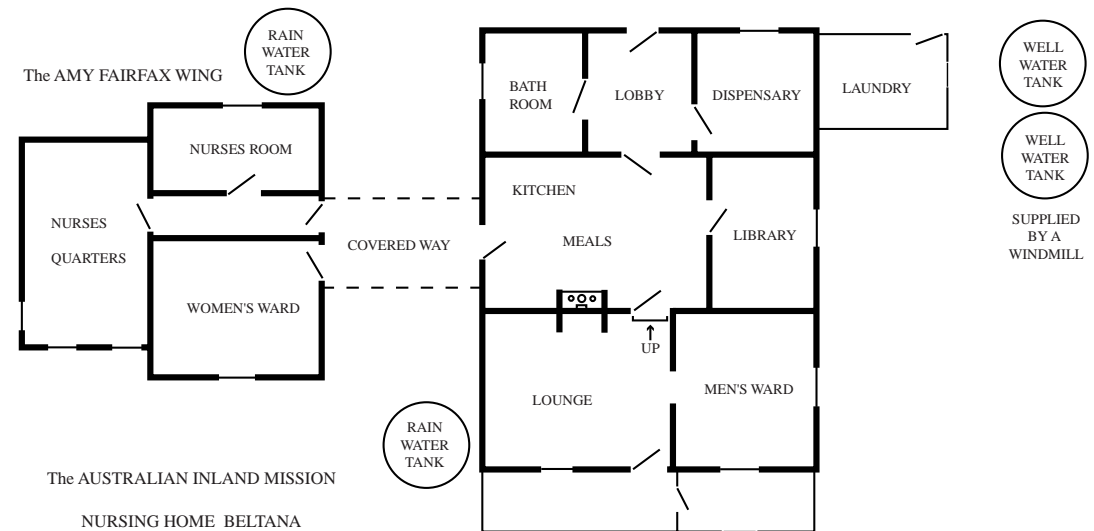

Rev. John Flynn (standing, centre)



Dr Wick Shepherd attended from Hawker during 1940s



Amy Fairfax

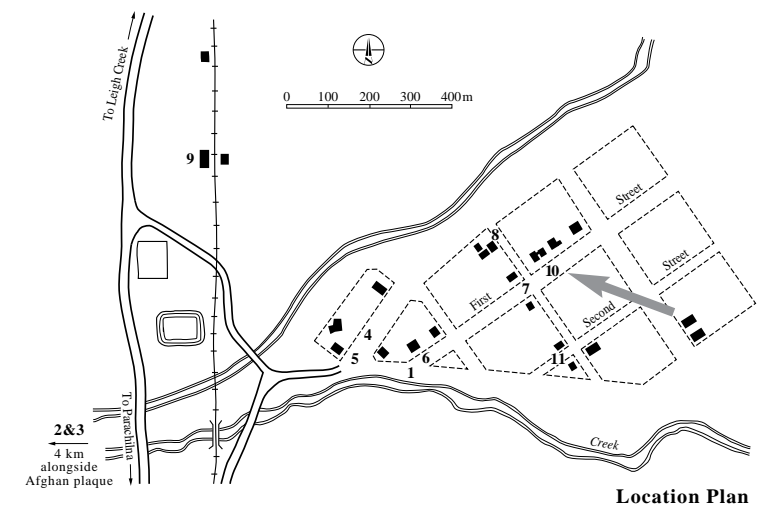

Location Plan



The Beltana Sport & Social Progress Association
and the Beltana Memorial Committee
Supported by the Commonwealth



Heritage South Australia
Government of South Australia